



# Sceideal 1 / Schedule 1

## LIMISTÉAR FAOI CHAOMHNÚ SPEISIALTA SPECIAL AREA OF CONSERVATION

-  Limistéar faoi Chaomhnú Speisialta  
Special Area of Conservation
-  Rialachán 4(1)(b) Innéacs Mapa Mionsonraithe  
Regulation 4(1)(b) Detail Map Index

LCS Phortach Choill Salach  
Kilsallagh Bog SAC  
000285

Achar / Area 277.83 ha



Co. na Gaillimhe  
Co. Galway

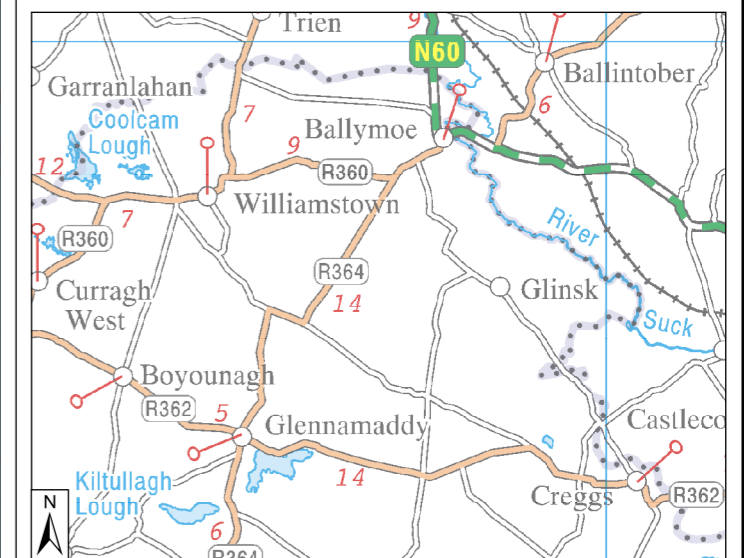

Suirbhéireacht Ordanáis Éireann Ceadúnas Uimhir OSI-NMA-014 © OSI / Rialtas na hÉireann  
Ordnance Survey Ireland Licence No. OSI-NMA-014 © Ordnance Survey Ireland / Government of Ireland  
Córas Comhordanáidí: Trasteilgean Mercator na hÉireann / Co-ordinate System: Irish Transverse Mercator

Leagan / Version: 3.01

Arna chló an / Printed on: 23/11/2021

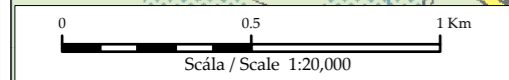
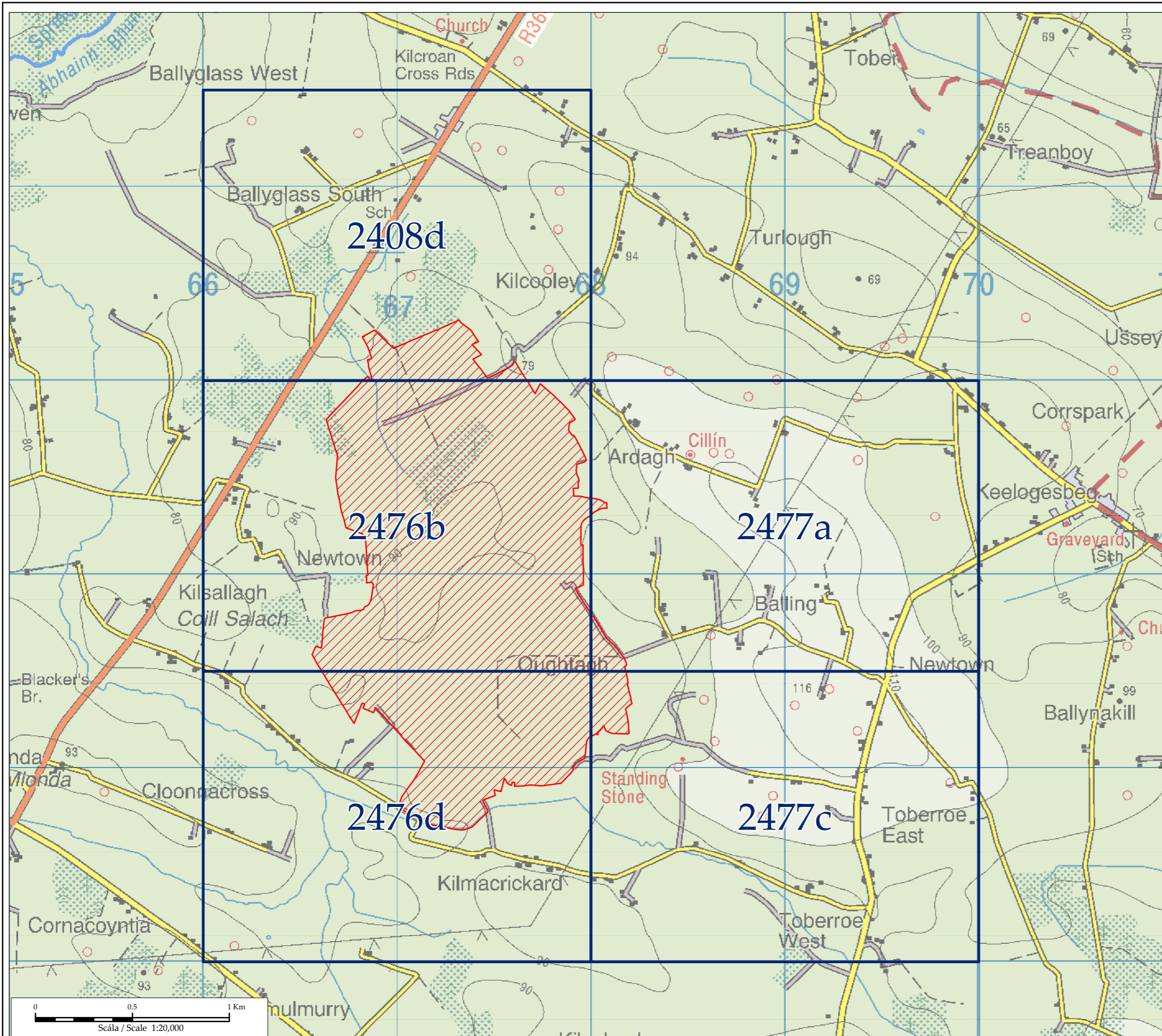

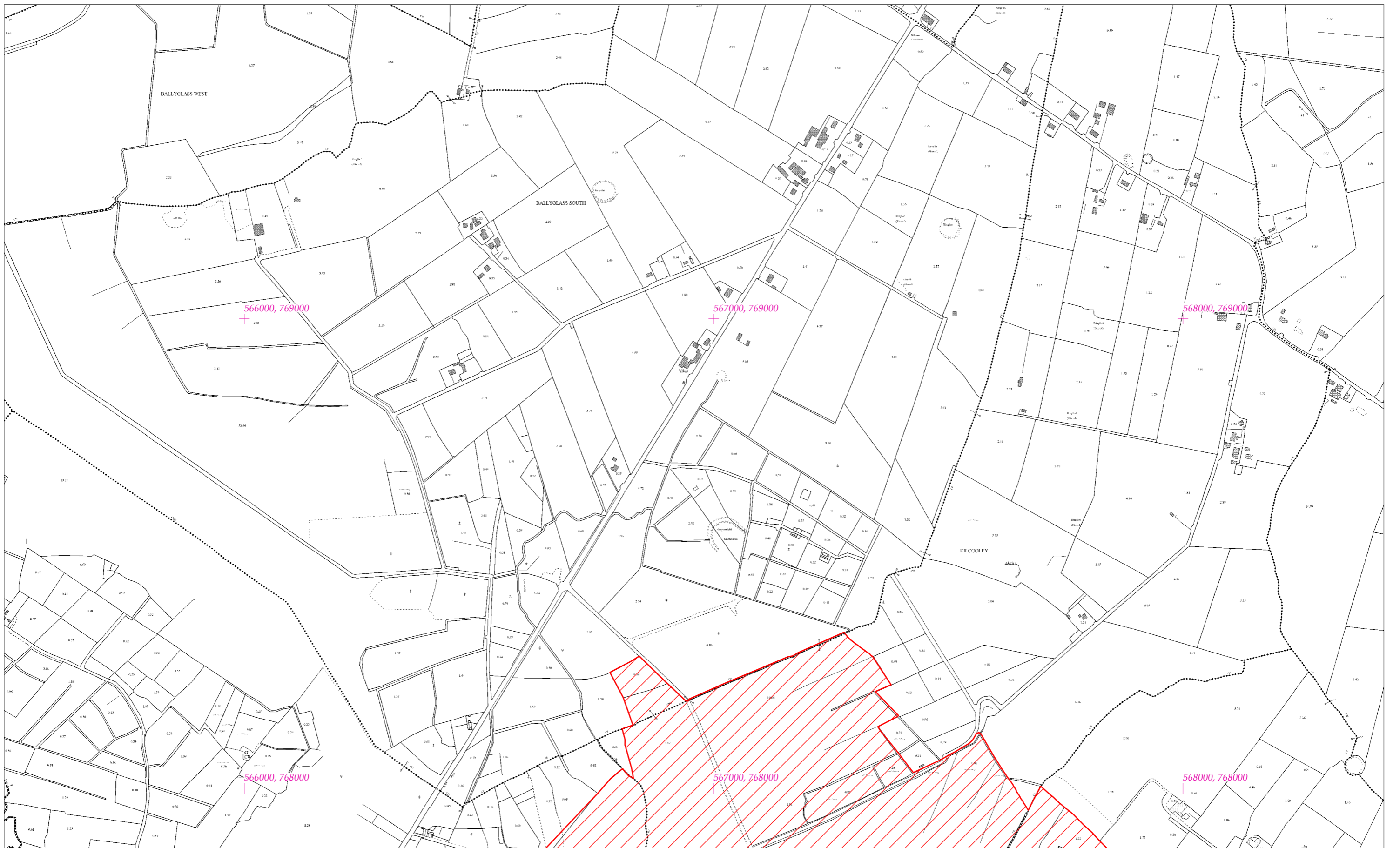

Rialachán 4(1)(b) / Regulation 4(1)(b)

Leathanach 1 de 5 (Co. na Gaillimhe)  
Page 1 of 5 (Co. Galway)

LIMISTÉAR FAOI CHAOMHNÚ SPEISIALTA  
SPECIAL AREA OF CONSERVATION

Suirbhéireacht Ordanáis Éireann Ceadúnas Uimhir OSI-NMA-014 © OSI / Rialtas na hÉireann  
Ordnance Survey Ireland Licence No. OSI-NMA-014 © Ordnance Survey Ireland / Government of Ireland  
Córas Comhordanáidí: Trasteilgean Mercator na hÉireann / Co-ordinate System: Irish Transverse Mercator

LCS Phortach Choill Salach  
Kilsallagh Bog SAC  
1:5000 O.S. TILE 2408d 1 of 5

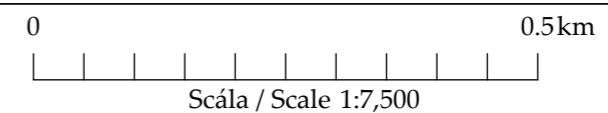

SITE CODE  
000285

Leagan / Version: 3.01  
Arna chló an / Printed on: 11/11/2021



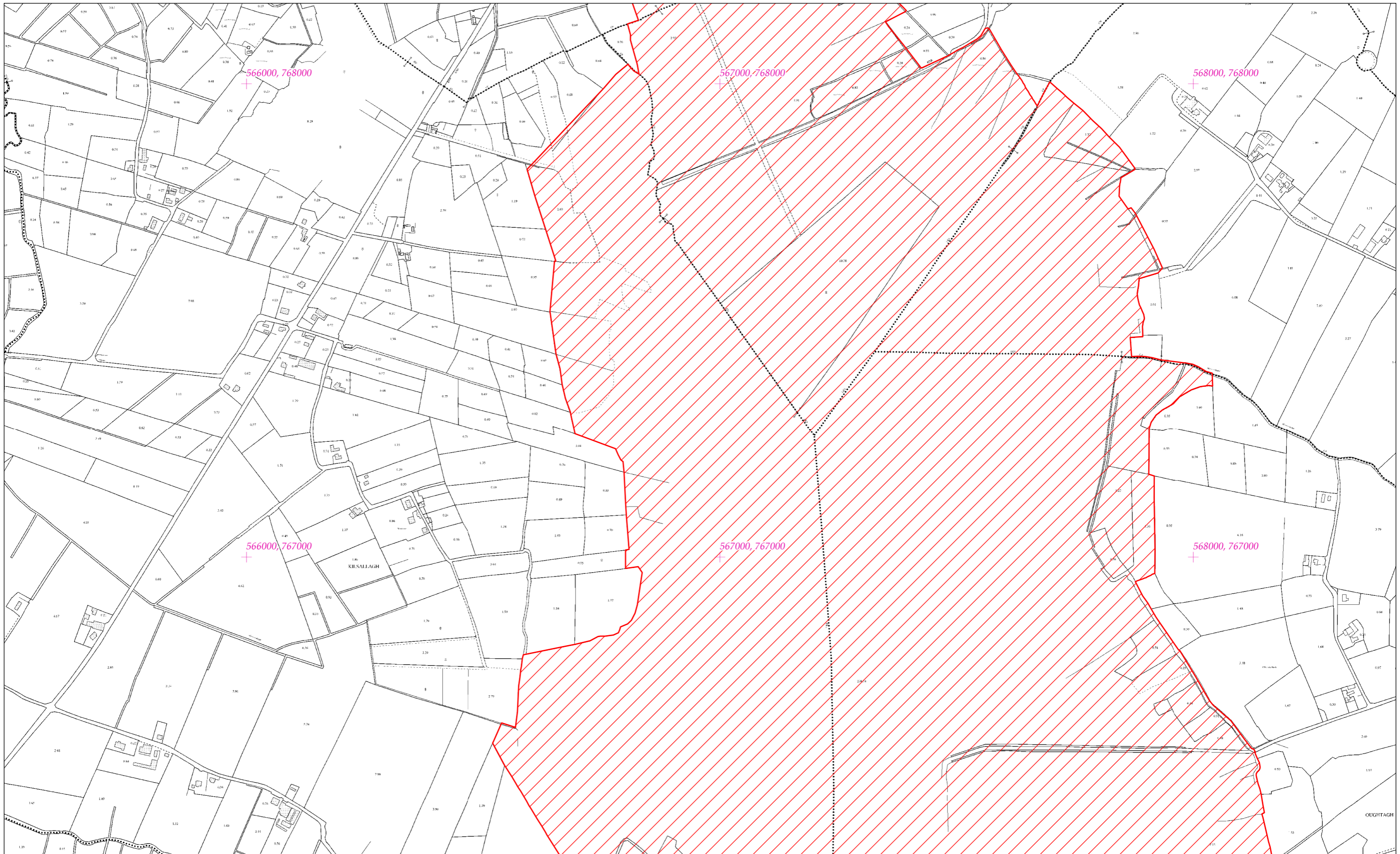

Rialachán 4(1)(b) / Regulation 4(1)(b)

Leathanach 2 de 5 (Co. na Gaillimhe)  
Page 2 of 5 (Co. Galway)

LIMISTÉAR FAOI CHAOMHNÚ SPEISIALTA  
SPECIAL AREA OF CONSERVATION

Suirbhéireacht Ordanáis Éireann Ceadúnas Uimhir OSI-NMA-014 © OSI / Rialtas na hÉireann  
Ordnance Survey Ireland Licence No. OSI-NMA-014 © Ordnance Survey Ireland / Government of Ireland  
Córas Comhordanáidí: Trasteilgean Mercator na hÉireann / Co-ordinate System: Irish Transverse Mercator

LCS Phortach Choill Salach  
Kilsallagh Bog SAC  
1:5000 O.S. TILE 2476b 2 of 5



SITE CODE  
000285

Leagan / Version: 3.01  
Arna chló an / Printed on: 11/11/2021

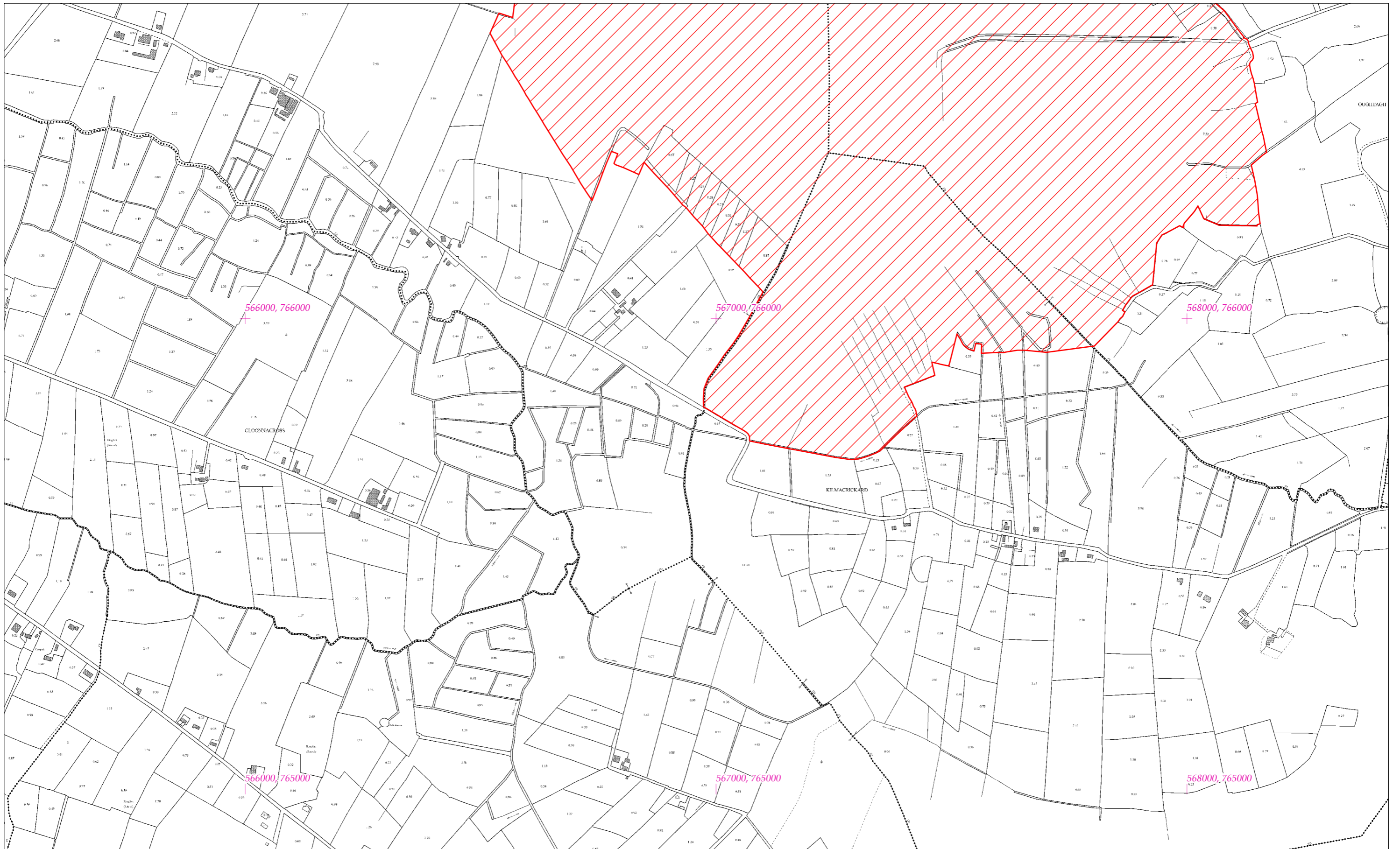

Rialachán 4(1)(b) / Regulation 4(1)(b)

Leathanach 3 de 5 (Co. na Gaillimhe)  
Page 3 of 5 (Co. Galway)

LIMISTÉAR FAOI CHAOMHNÚ SPEISIALTA  
SPECIAL AREA OF CONSERVATION

Suirbhéireacht Ordanáis Éireann Ceadúnas Uimhir OSI-NMA-014 © OSI / Rialtas na hÉireann  
Ordnance Survey Ireland Licence No. OSI-NMA-014 © Ordnance Survey Ireland / Government of Ireland  
Córas Comhordanáidí: Trasteilgean Mercator na hÉireann / Co-ordinate System: Irish Transverse Mercator

LCS Phortach Choill Salach  
Kilsallagh Bog SAC  
1:5000 O.S. TILE 2476d 3 of 5



SITE CODE  
000285

Leagan / Version: 3.01  
Arna chló an / Printed on: 11/11/2021

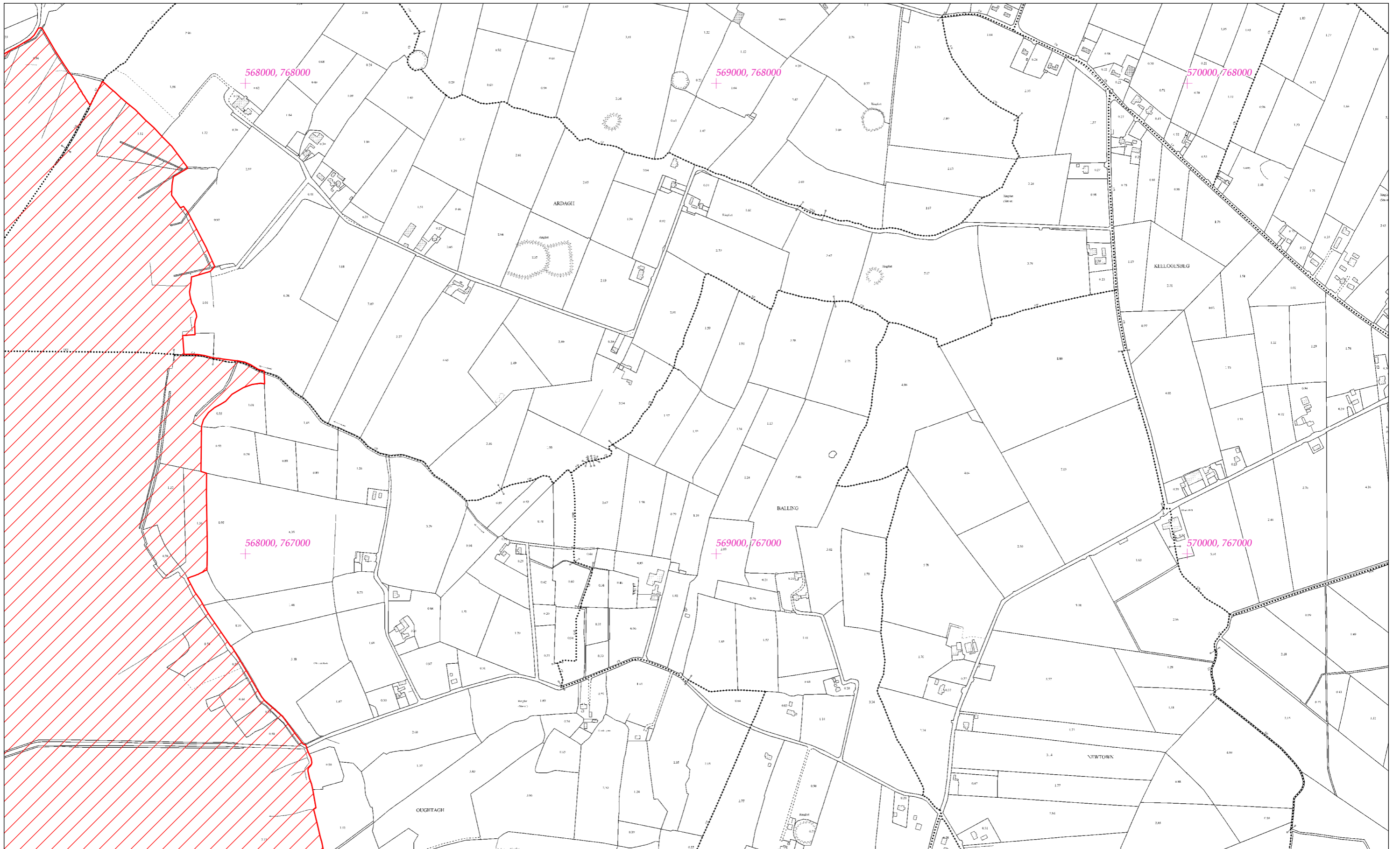

Rialachán 4(1)(b) / Regulation 4(1)(b)

Leathanach 4 de 5 (Co. na Gaillimhe)  
Page 4 of 5 (Co. Galway)

LIMISTÉAR FAOI CHAOMHNÚ SPEISIALTA  
SPECIAL AREA OF CONSERVATION

Suirbhéireacht Ordanáis Éireann Ceadúnas Uimhir OSI-NMA-014 © OSI / Rialtas na hÉireann  
Ordnance Survey Ireland Licence No. OSI-NMA-014 © Ordnance Survey Ireland / Government of Ireland  
Córas Comhordanáidí: Trasteilgean Mercator na hÉireann / Co-ordinate System: Irish Transverse Mercator

LCS Phortach Choill Salach  
Kilsallagh Bog SAC  
1:5000 O.S. TILE 2477a 4 of 5

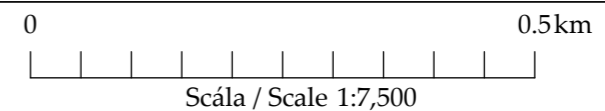

SITE CODE  
000285

Leagan / Version: 3.01  
Arna chló an / Printed on: 11/11/2021



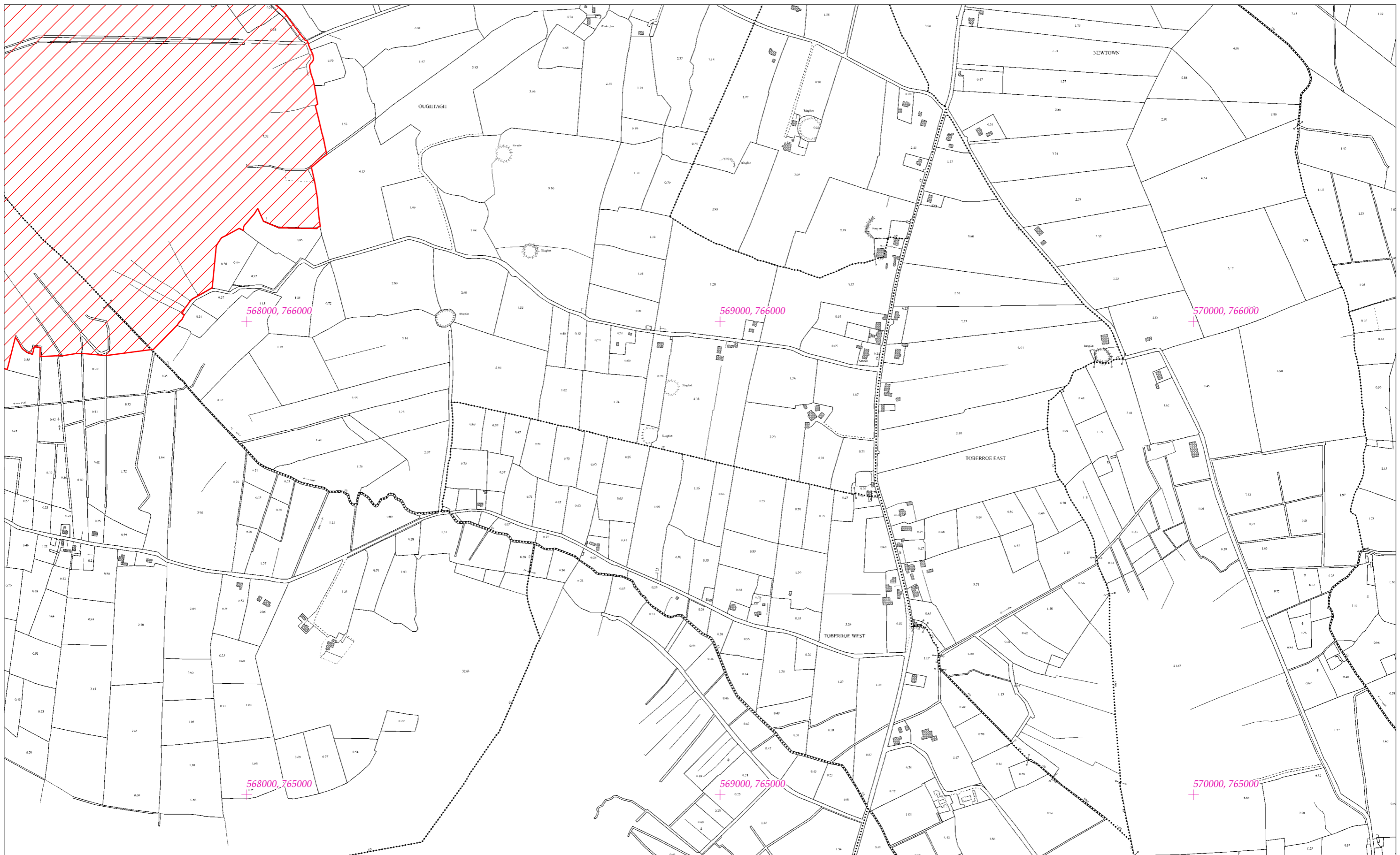

Rialachán 4(1)(b) / Regulation 4(1)(b)

Leathanach 5 de 5 (Co. na Gaillimhe)  
Page 5 of 5 (Co. Galway)

LIMISTÉAR FAOI CHAOMHNÚ SPEISIALTA  
SPECIAL AREA OF CONSERVATION

Suirbhéireacht Ordanáis Éireann Ceadúnas Uimhir OSI-NMA-014 © OSI / Rialtas na hÉireann  
Ordnance Survey Ireland Licence No. OSI-NMA-014 © Ordnance Survey Ireland / Government of Ireland  
Córas Comhordanáidí: Trasteilgean Mercator na hÉireann / Co-ordinate System: Irish Transverse Mercator

LCS Phortach Choill Salach  
Kilsallagh Bog SAC  
1:5000 O.S. TILE 2477c 5 of 5



SITE CODE  
000285

Leagan / Version: 3.01  
Arna chló an / Printed on: 11/11/2021