

Detail A: Typical Cross Section of Mobility Hub Canopy

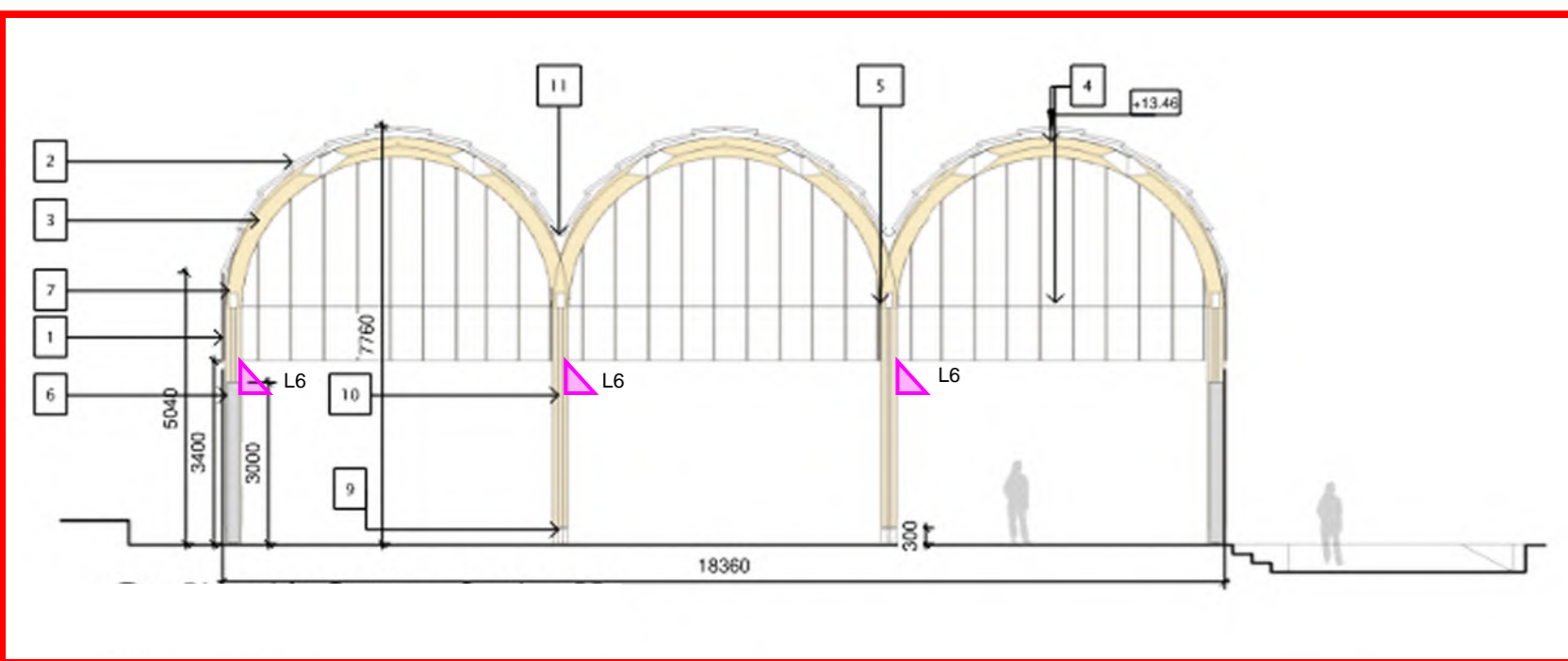

Detail B: Typical Cross Section of Riverside Canopy

Notes:
To be updated with final site plan for submission

Legend:

Ref	Image	Description
L1		Urban Axis 4m column, 1m outreach 2700 Kelvin
L1x		As above but mounted at the lower height of 3.5m
L2		KTY254 Bollard 1m bollard 2700K
L3		Scheder Allura 4m columns 2700 Kelvin
L3x		As above but mounted at the lower height of 3.5m
L4		DW Windsor Garda Pro 1.2m handrail light 2700 Kelvin
L5		Rego Recessed wall luminaire 0.3-0.5 m mounting height 2700 Kelvin
L6		Waterwell Spectre VX 3m wall mounted 3000K
L7		Thorn Lighting Isoo 8m column Single or double arm - 1m outreach 2700 Kelvin
L8		Scheder Tecco on Thyra Pole Double arm - 4.2m and 6.2 m mounting heights 2700K
L8s		As above but single arm - 4.2m
L8t		As above but triple arm - 2No. 6.2m and 1No. 4.2m

AM	AM	VA
AM	AM	VA
AM	AM	VA
AM	AM	VA
AM	AM	VA
AM	AM	VA
By	CHK'd	App'd



Twenty Thirty

Residential

.ayout

Calculation Targets			
Class	Min Avg (lux)	Min Point (lux)	Min Uniformity
P3	7.5	1.5	0.2